

FOR LEASE

112th Avenue Business Park

3002-3006 NE 112th Ave.
Vancouver, WA 97220

PACIFIC NW
PROPERTIES



Imagine working in a
perfect space.

Location

- Conveniently located off NE 112th Ave in Vancouver
- Excellent access to 4th Plain, SR-500, and I-205
- Close to amenities: Vancouver Mall, food, shopping, fitness, and hotels.

Building Highlights

- Warehouse/Office space for lease
- Flexible sizes and configurations
- Modern Finishes
- Dock and grade loading
- Well-maintained business park setting
- Locally-owned and managed
- Please call for competitive pricing and more info



For more information, please contact:
Mitch Page

(503)626-3500

mitch.page@pnwprop.com

FOR LEASE

112th Avenue Business Park

3002-3006 NE 112th Ave.
Vancouver, WA 97220

PACIFIC NW
PNW PROPERTIES

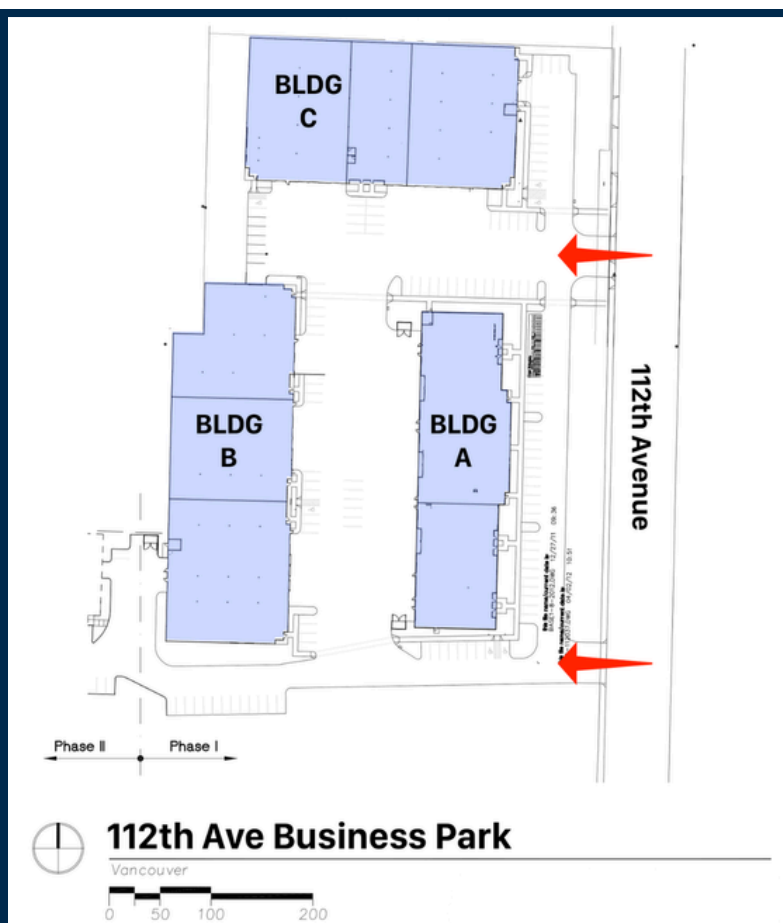
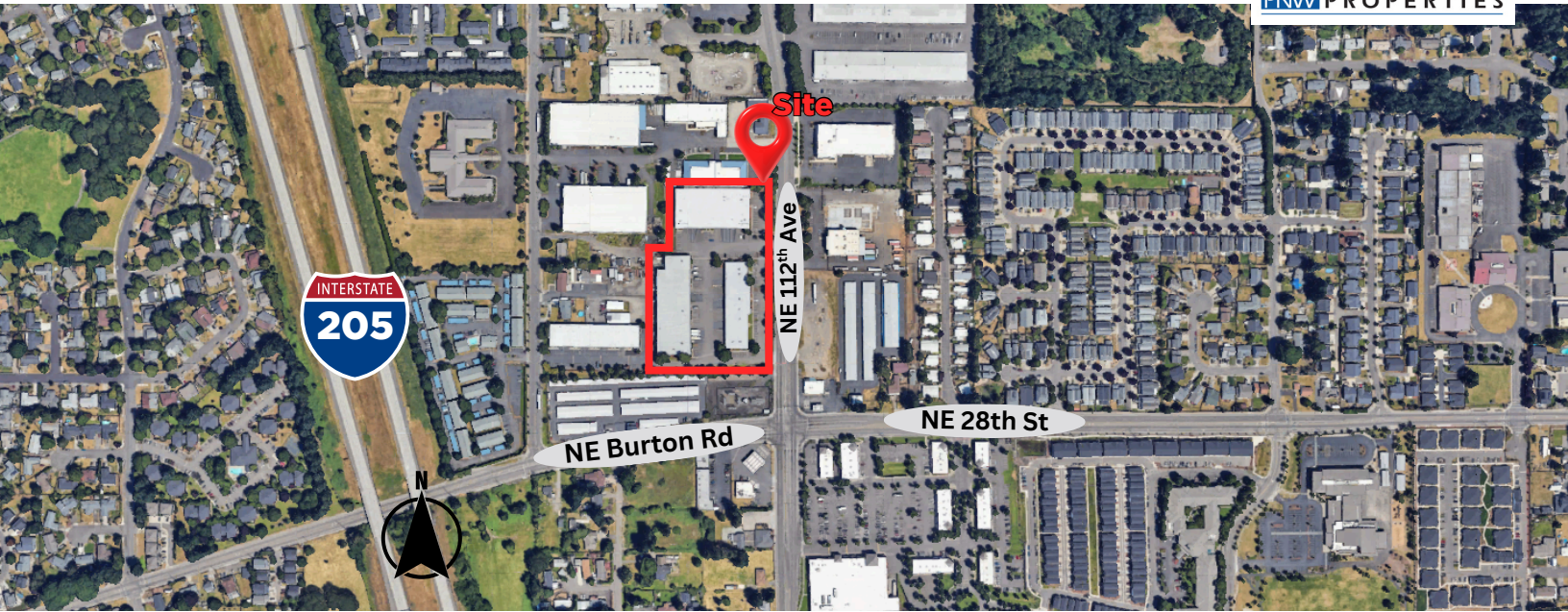

For more information, please contact:
Mitch Page

(503)626-3500

mitch.page@pnwprop.com