

FOR LEASE

Kelso I-5 Warehouse

2680 Coweeman Park Drive
Kelso, WA 98626

PACIFIC NW
PNW PROPERTIES



Imagine working in a
perfect space.

Location

- Well-located off I-5 and the SR-432 interchange, and just East of Longview

Building Highlights

- Approximately 7,600 SF of shop building, including approx. 720 square feet of office space
- Secure paved and fenced yard, accessible by gates on either side of the building
- 4 grade level loading doors (12' x 14' & 12' x 16')
- Approximately 16'+ clear height
- Regional Commercial (RC) zoning, City of Kelso, allowing a variety of industrial and retail uses
- Free-standing building with prominent signage
- Locally-owned and managed by Pacific NW Properties
- Please call for competitive pricing

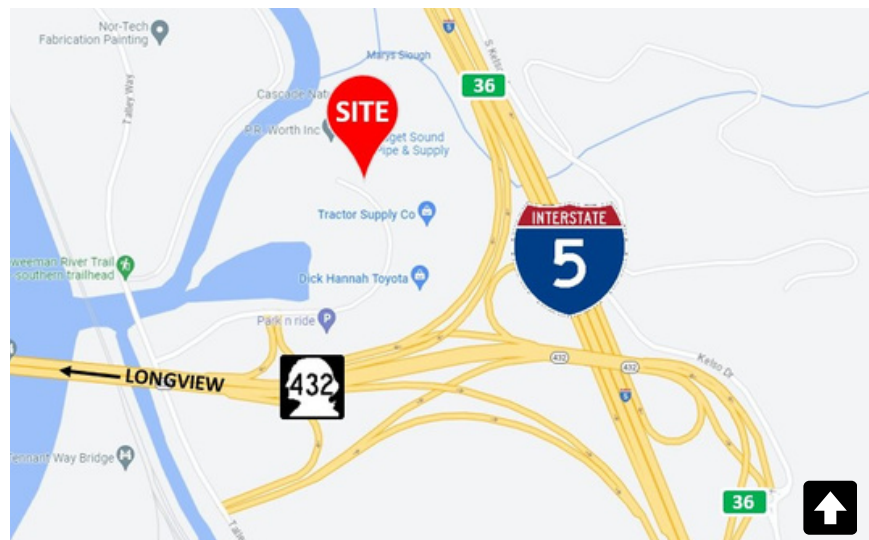

For more information, please contact:

Mitch Page

(503) 626-3500

mitch.page@pnwprop.com

503-626-3500 | pnwprop.com

FOR LEASE

Kelso I-5 Warehouse

2680 Coweenman Park Drive
Kelso, WA 98626

Because great people should have
great places.

PACIFIC NW
PNW PROPERTIES



Floor Plan

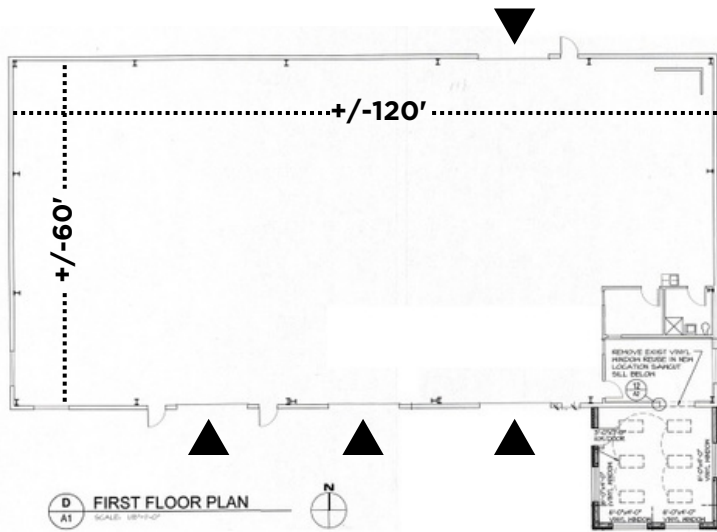

For more information, please contact:

Mitch Page

(503) 626-3500

mitch.page@pnwprop.com

503-626-3500 | pnwprop.com